

revision	drawn	checked	date	no.

LEGEND

- EXISTING BOUNDARY WALL TO BE RETAINED (COPING, NEW OPES & EDGE CONDITIONS TO BE MADE GOOD AS PER CONSERVATION ARCHITECT'S METHODOLOGY)
- EXISTING BOUNDARY WALL TO BE REDUCED IN HEIGHT (NEW LIMESTONE CAPPING ADDED)
- EXISTING BOUNDARY WALL TO BE DEMOLISHED (STONES TO BE RE-USED TO RE-BUILD UPPER PORTION WHERE INDICATED (E) IN ACCORDANCE WITH CONSERVATION ARCHITECT'S METHODOLOGY)
- EXISTING BOUNDARY WALL PREVIOUSLY RECONSTRUCTED TO BE DEMOLISHED
- EXISTING CONTEMPORARY WALL TO BE DEMOLISHED (NOT PART OF ORIGINAL BOUNDARY WALL)
- EXISTING GROUND LINE BEHIND
- BS BOUNDARY STONE

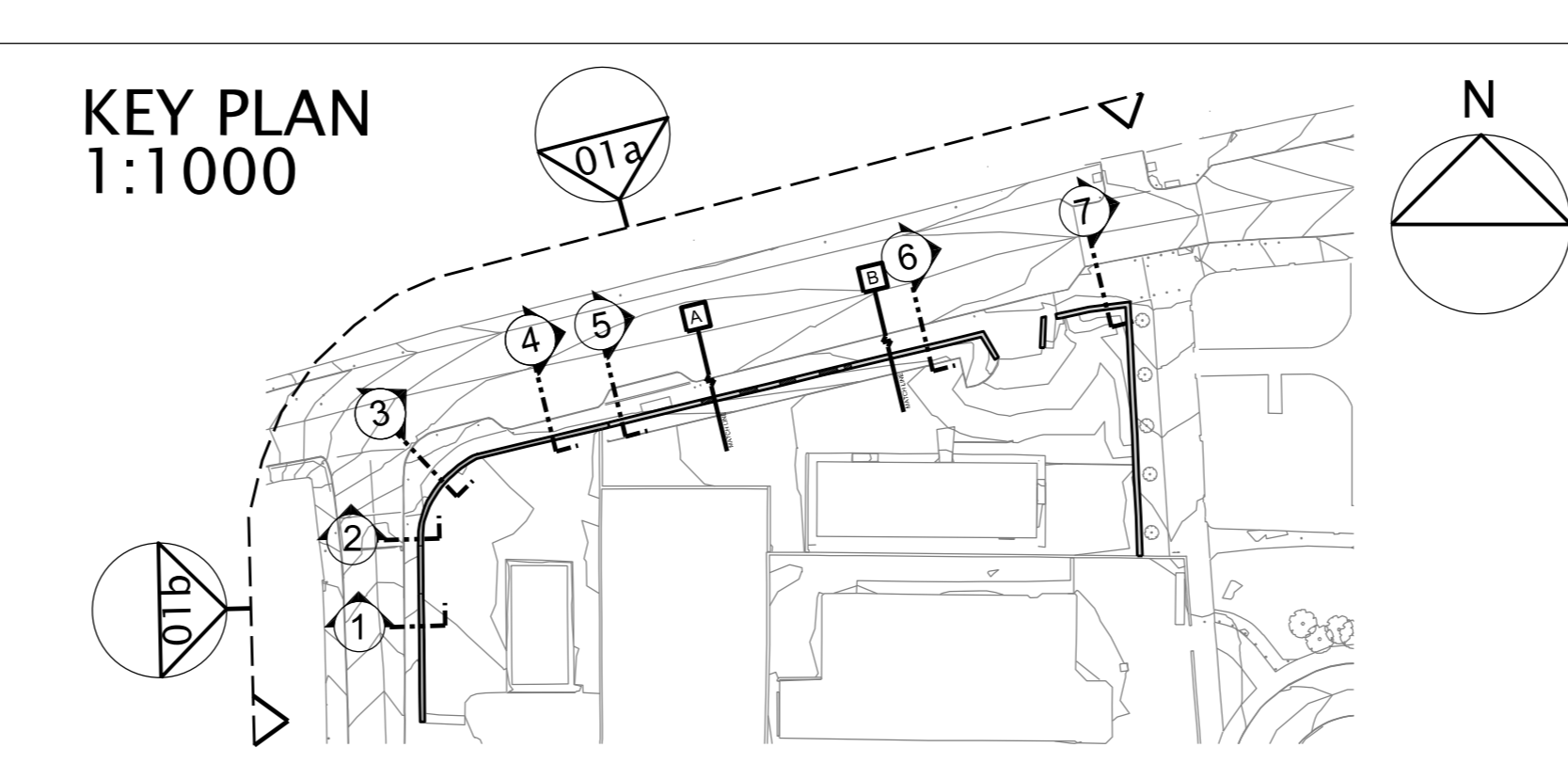

NOTES:
 All levels and dimensions on this sheet are to be checked on site. No dimensions are to be scaled. Any discrepancies on this sheet are to be reported to the architect. All work on this sheet is subject to copyright. All work to comply with the Building Regulations.
 HISTORIC WALL REFERS TO REMAINS OF BOUNDARY WALL OF RICHMOND BARRACKS PREVIOUSLY LOCATED ON THE SITE. REFER TO ARCHITECTURAL HERITAGE IMPACT ASSESSMENT REPORT FOR FURTHER INFORMATION. DETAILS SUBJECT TO DETAILED DESIGN DEVELOPMENT - TO BE READ IN CONJUNCTION WITH ARCHITECTURAL DESIGN REPORT.

STAGE PLANNING

drawing: **BARRACKS WALL - EXISTING / DEMOLITION - PLAN, SECTIONS AND ELEVATION**

drawing no.: **0318-C-A6-00** scale: 1:100 @ A0 drawn: SJ project no.: 0318
 date: SEPT 22 checked: KH revision:

project: **DEVELOPMENT AT EMMET ROAD, DUBLIN 8**

client: **Dublin City Council**

bucholzmcveyARCHITECTS

UNIT C MOUNTPLEASANT BUSINESS CENTRE UPPER MOUNTPLEASANT AVENUE DUBLIN 6 IRELAND
 T +353 1 496 6340 F +353 1 496 6341 INFO@BMCEA.COM WWW.BMCEA.COM